

L3T Series

Tubular Lever Lock

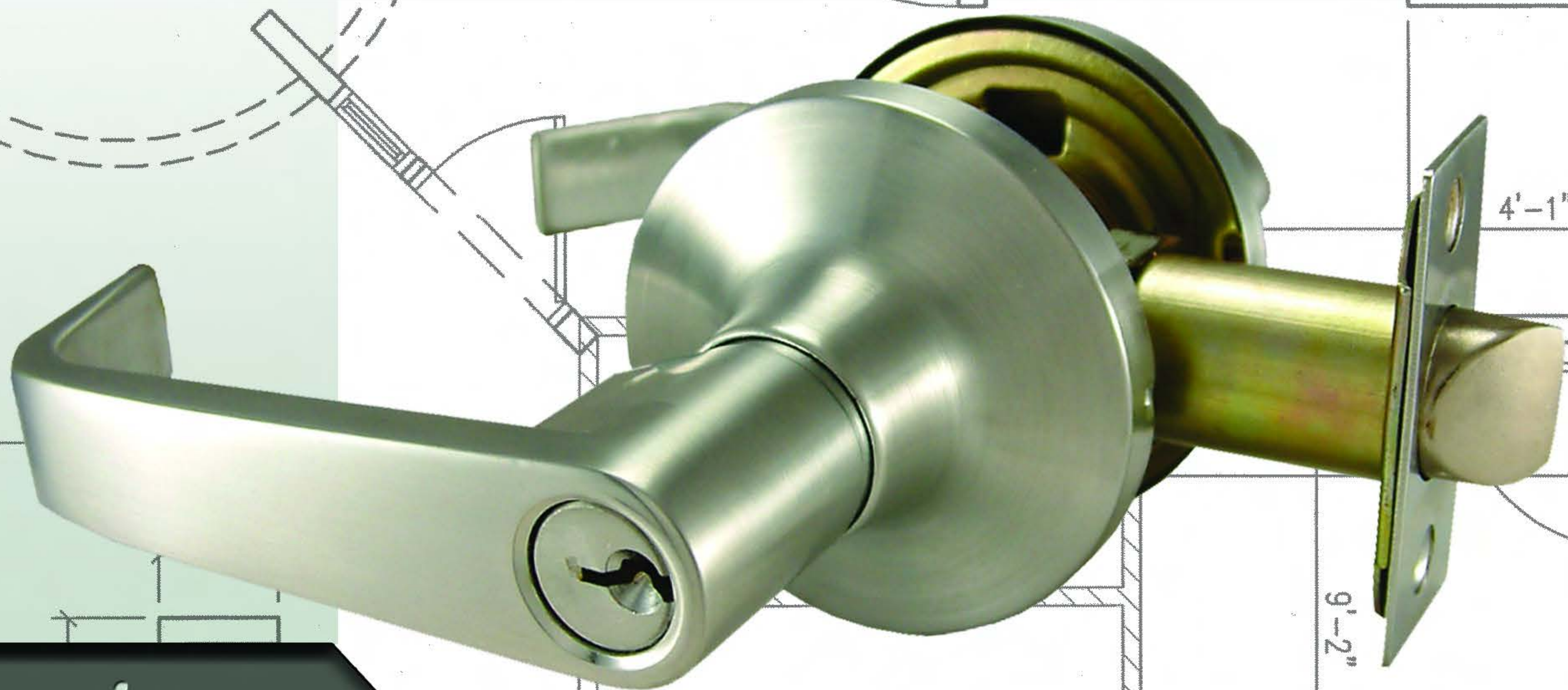

Specifications

ANSI: Meets ANSI - A156.2 Grade 3 Standards

ADA Compliance: Meets ADA and ANSI A117.1 accessibility codes (except F76 & F82 functions)

Lock Chassis: Steel, Zinc dichromated for Corrosion Resistance

Trim: 4" solid zinc diecast levers, 2 1/2" wrought brass roses

Handing: Non-Handed - Completely reversible (some levers are handed due to style)

Backset & Latchface: 6 Way Latch - Adjustable for 2 3/8" or 2 3/4" backset with 1" x 2 1/4" square corner latchface - Conversion parts included for 1" x 2 1/4" x 1/4" radius corner & Drive-In latch

Latchbolt: Nickel Plated Zinc with 1/2" projection, Deadlocking on keyed functions

Cylinder Options: 5 Pin Solid Brass, C Keyway, 2 Silver Nickel Keys, Cylinder plug faces match lock finish

Strikes: 2 3/4" T strike & Full lip strike w/ 1/4" R.C. standard, 4 7/8" ASA available

Door Preparation: ANSI A115.2 - 2 1/8" crossbore

Door Thickness: 1 3/8" to 2" thick doors

Standard Lever Design: Flat (standard, shown above) (stocked in US26D)

Other Lever Choices: Curved, Half Curved, S-A, C-2

Standard Finishes: US26D

Special Order Finishes: US3 PVD*, US4, US10B, US15, US26 PVD* (PVD = Lifetime Finish)

Fasteners: Combination screws for wood or metal doors & frames

Warranty: 3 Year Warranty



211 Endeavor Drive - PO Box 680
Rogersville, MO 65742
PH 877-258-1262 FX 877-888-0150
www.designhardware.net